

# FIREXPIRE® RE-ASSEMBLY AND MAINTENANCE

(Brunel, Centuro, Futuro and Grampian)

Please note: Firexpire is an effective low cost auxiliary device and must never replace primary fire prevention measures. Obstructions preventing the plate from dropping may adversely affect the function of the unit, and as many Firexpire devices are used in unsupervised locations, regular inspection and immediate replacement of any damaged or distorted components is essential.

## HOW IT WORKS

The Firexpire system includes four important components.

1. Spacer
2. Firexpire extinguishing plate
3. Thermoplastic trigger washer
4. Panhead screw

It works by having a plate suspended above aperture height secured by a panhead screw and a thermoplastic trigger washer. When a fire occurs inside the liner, the resulting heat deforms the thermoplastic washer which then releases the Firexpire plate. This then drops onto the liner sealing the liner and starving the fire within of oxygen, thus snuffing out the fire.

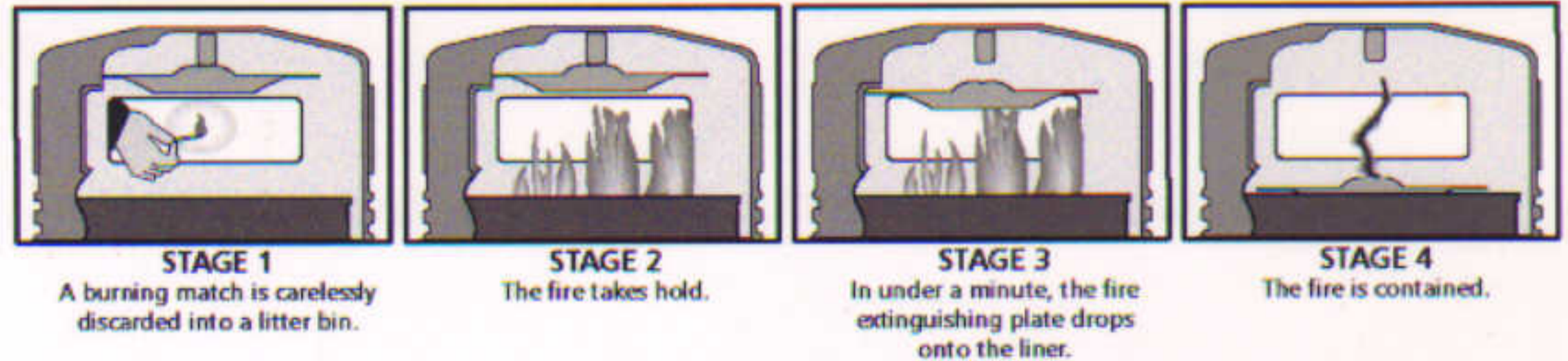

READ CAREFULLY BEFORE REPLACING FIREXPIRE - IMPORTANT - PASS ON TO END USER.

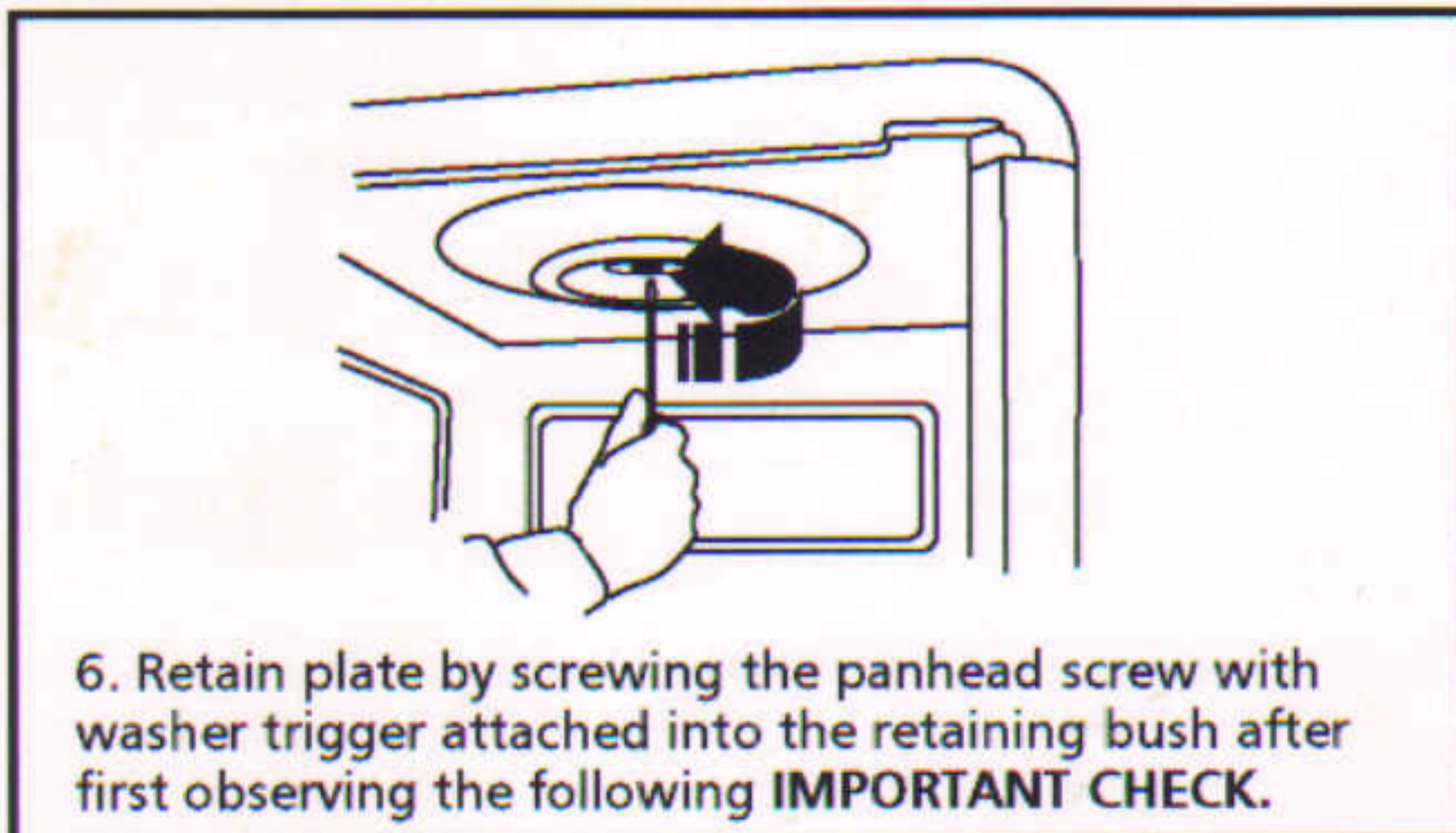
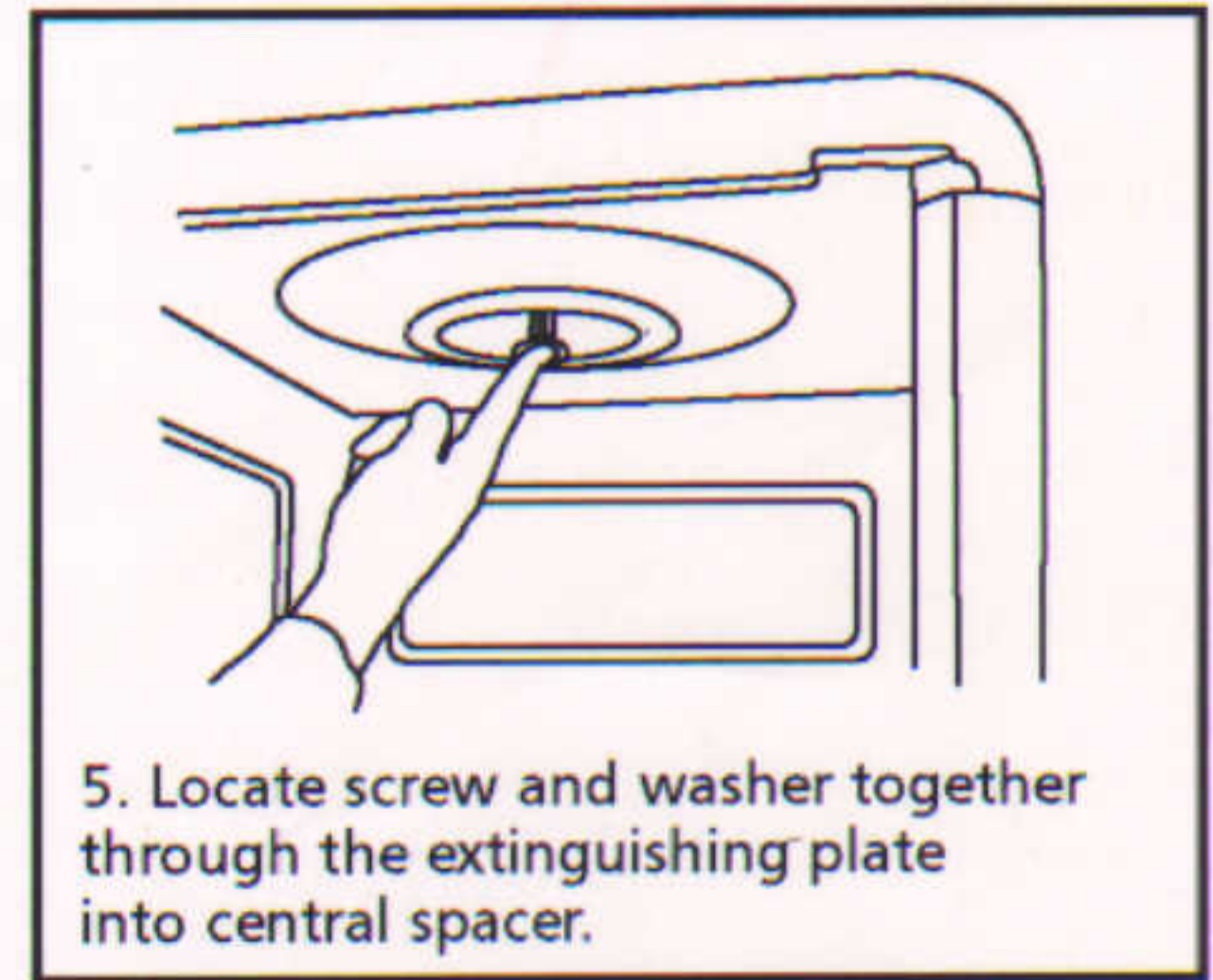
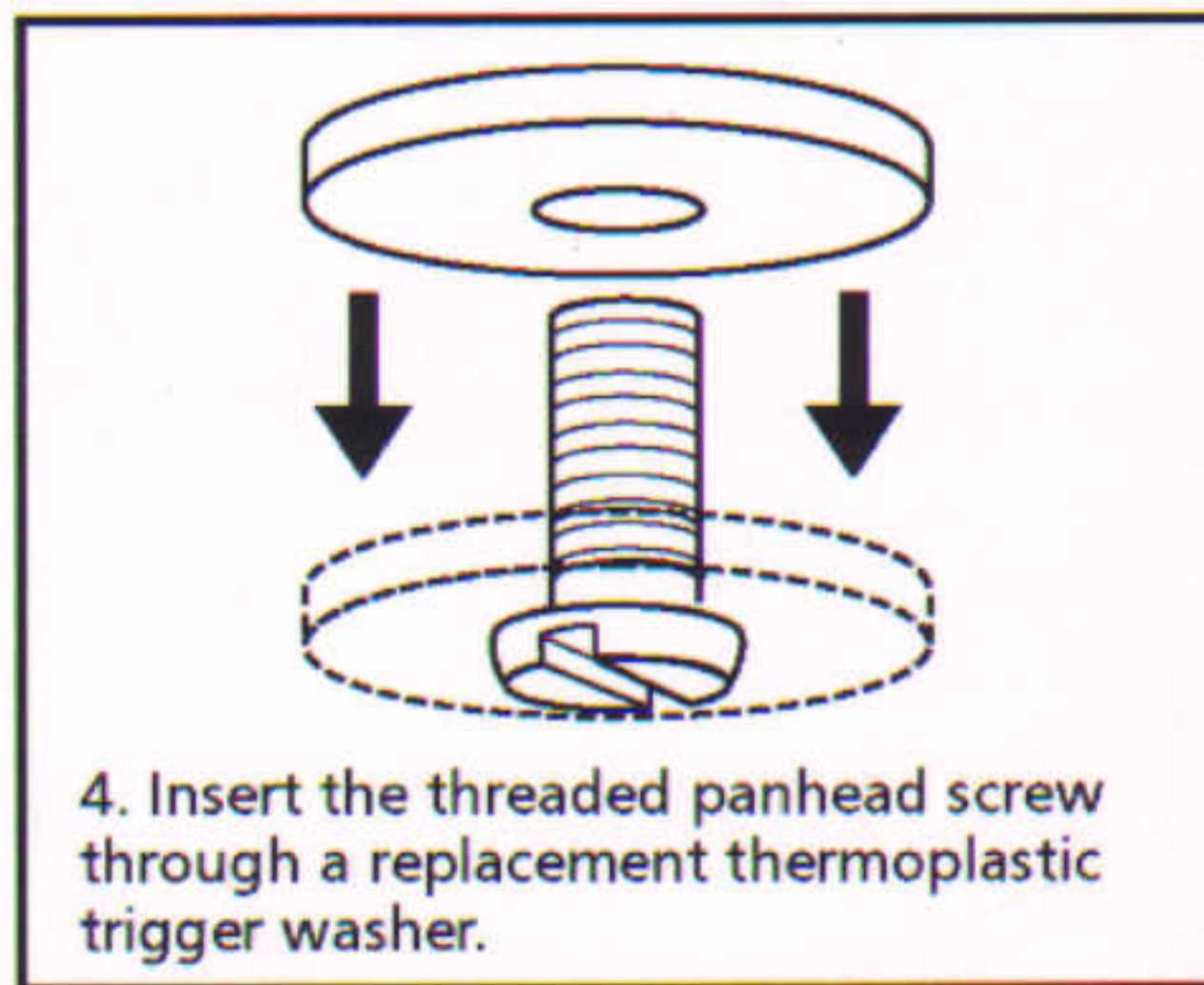
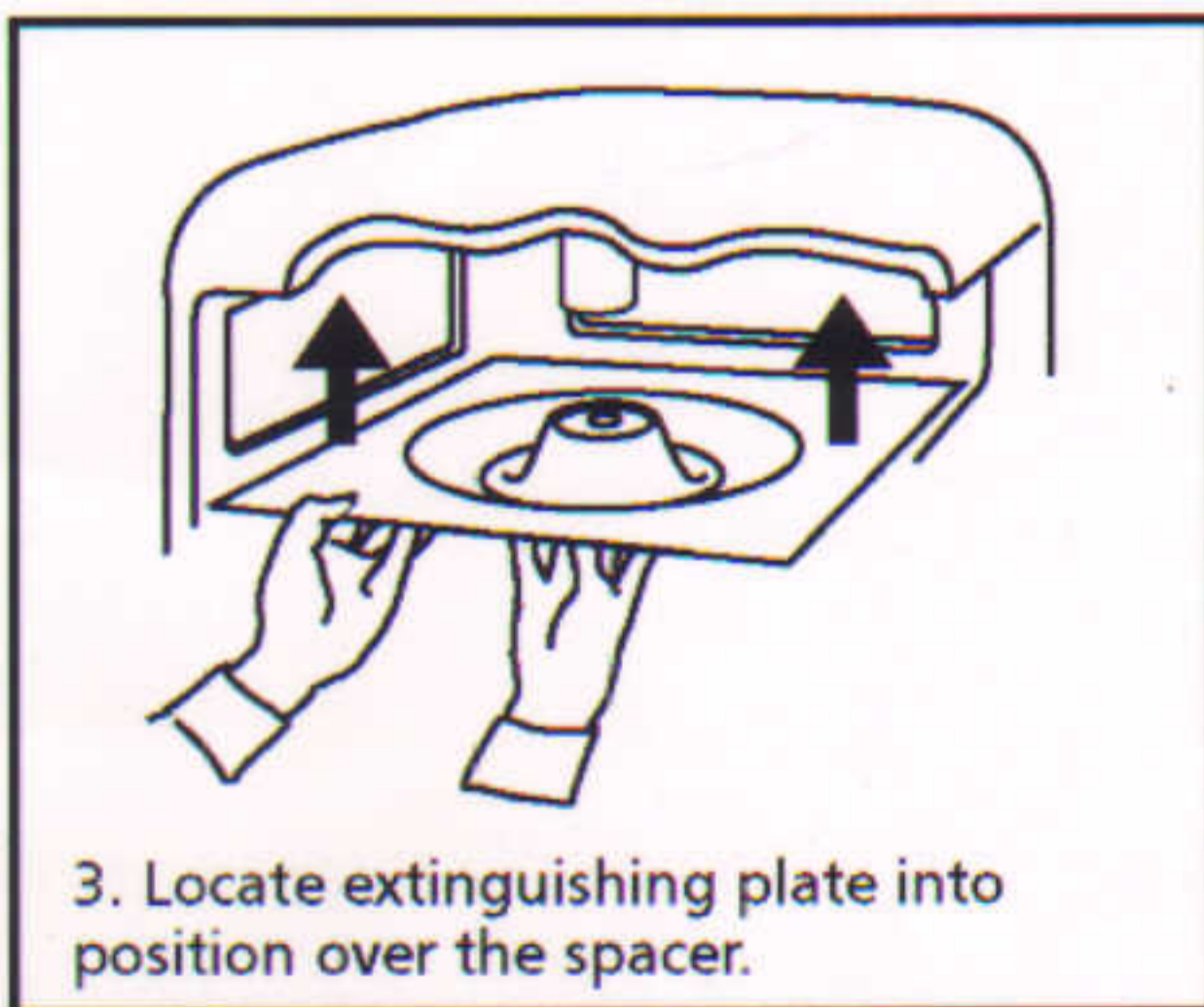
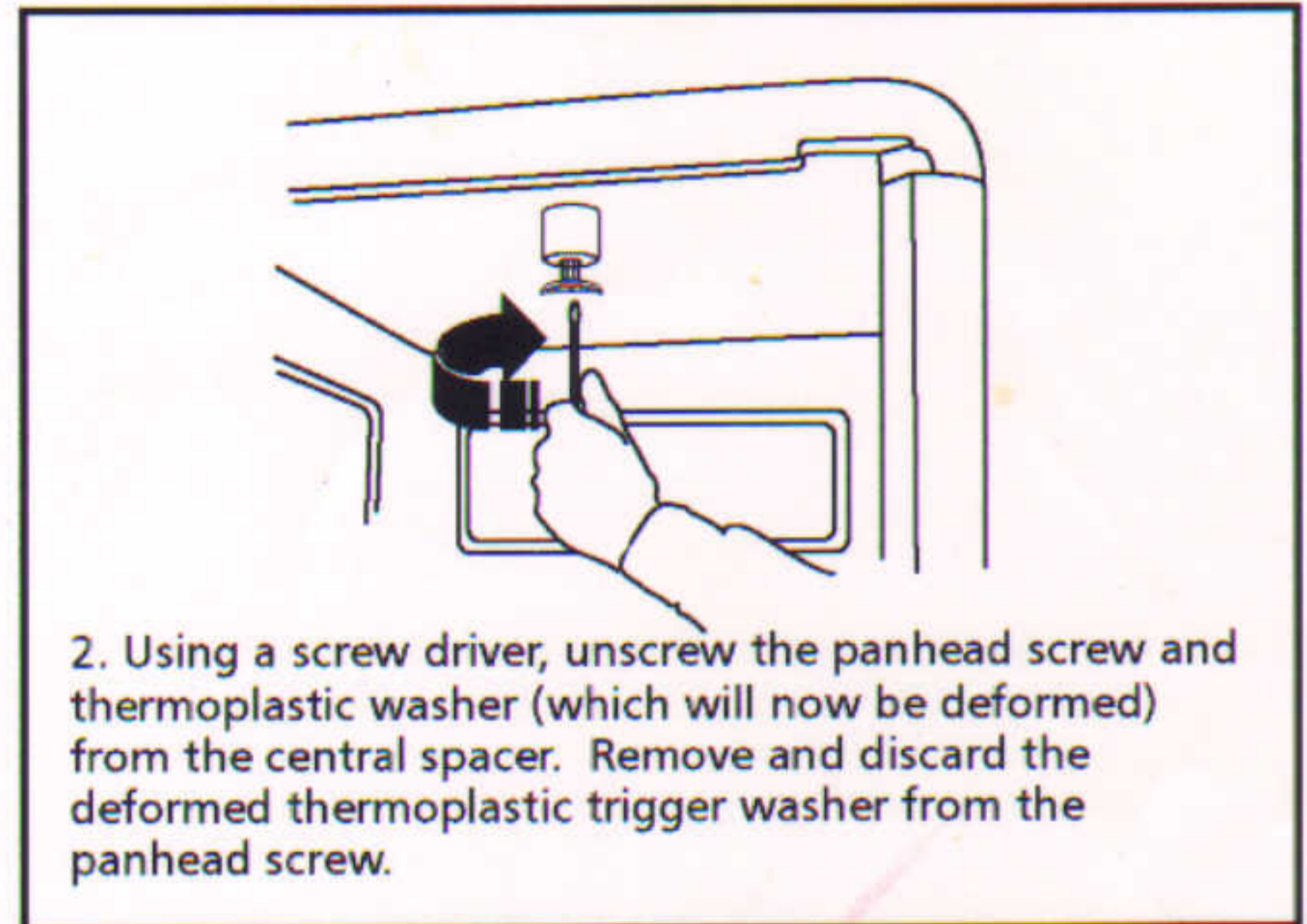
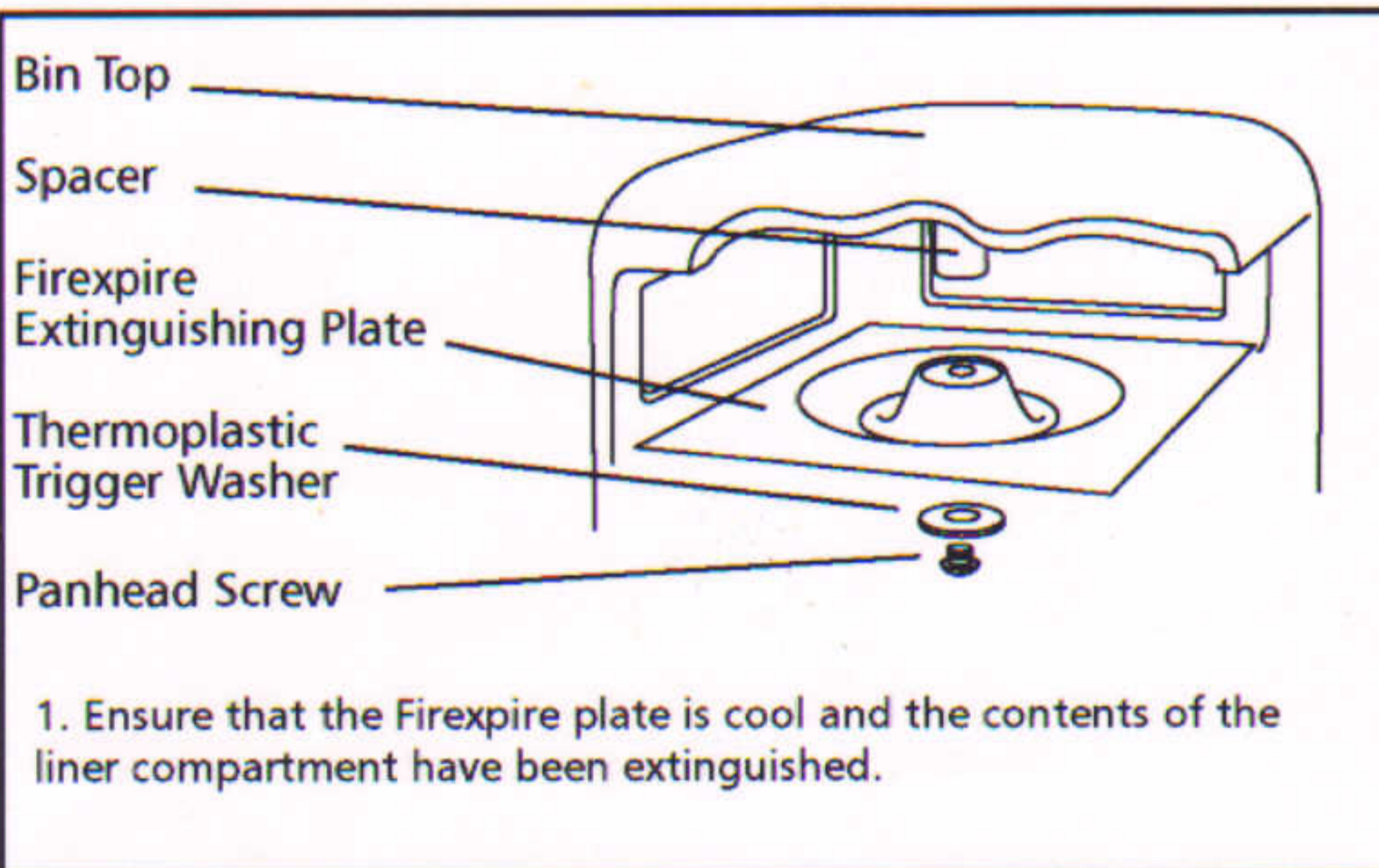

### IMPORTANT CHECK

Ensure Firexpire plate is absolutely central before tightening screw.

- A planned maintenance schedule of regular inspection is recommended, replacing components as necessary.
- Replacement components are available direct from Glasdon.
- Glasdon cannot be held responsible for claims arising from incorrect installation, unauthorised modification or misuse of the product.